

Detached Villa for sale in Benahavís, Benahavís

4.250.000 €

Referenz: SP0722 Schlafzimmer: 5 Badezimmer: 5 Grundstücksgröße: 2.210m² Garten: 605m² Terrasse: 522m²



FLOOR SURFACE HOUSE	
First floor	2076m ²
Main floor	172,48m ²
Entrance floor	155,48m ²
TOTAL	545,22m²
FLOOR SURFACE COVERED TERRACES	
First floor	155,51m ²
Main floor	112,32m ²
Entrance floor	140,72m ²
TOTAL	408,55m²
FLOOR SURFACE UNCOVERED TERRACES	
First floor	488m ²
Main floor	192,21m ²
Entrance floor	620m ²
TOTAL	1300,21m²
POOL SURFACE	
Lower floor	1826m ²
TOTAL	1826m²
TOTAL FLOOR SURFACE	1.187,74m²
TOTAL PLOT SIZE	2.210,00m²

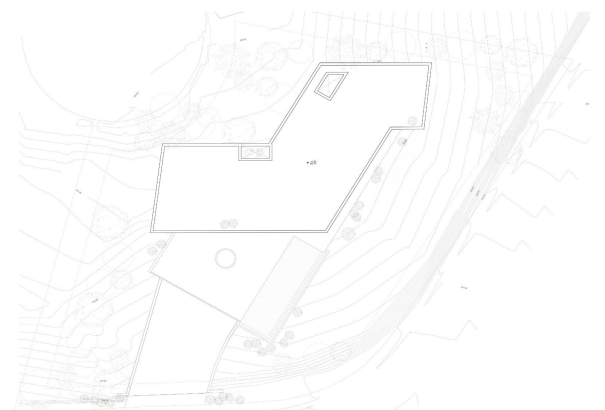

Costa del Sol, Benahavís

NEW BUILD LUXURY VILLA IN BENAHAVIS

Perched on an elevated position in the mountain foothills, New Build Luxury Villa is a masterful blend of strategic design and playful space distribution. With its back embraced by the mountain and its front opening to breath taking views.

The architecture and outdoor spaces are meticulously oriented towards the Mediterranean Sea, the castle of Monte Mayor, and the emerald valley below. From the expansive terraces to the integrated outdoor lounge area this villa offers a protected and serene haven. Every corner of this residence invites you to relax and enjoy the harmonious connection with nature.

The villa includes: 5 bedrooms, 5 en-suite bathrooms, 2 guest toilets, extensive terraces, an integrated outdoor lounge area and a stunning swimming pool. Villa radiates sophisticated charm with its use of noble materials and top-tier specifications. It achieves an ideal synergy between state-of-the-art design and ecological sensitivity, featuring a minimal environmental footprint, green roofs, optional solar energy, and landscaping designed to thrive in drought conditions.

For those who crave a refined lifestyle in a tranquil and scenic environment, villa presents a unique chance to experience luxurious living seamlessly integrated with nature.

A natural setting with magnificent views and an ideal location for this Villa close enough to the towns, beaches and amenities along the coast - secluded enough to offer a peaceful haven.

Located on the southern face of the Serrania de Ronda mountain range, Benahavís offers spectacular views and is a popular hot spot for locals and tourists alike.

Eigenschaften:

Merkmale

WC: 2

Gated

Private Pool

Double Bedrooms: 5

Beach: 7000 Meters

Near Commercial Center

Elevator/Lift

Number of Parking Spaces: 2

Views: Sea

Double Garage

Garden

Location: Coastal

Near Schools

Air Conditioning: Pre-Installed

Terrace: 522 Msq.

Useable Build Space: 484 Msq.

Energiebewertung

B

CO2 -Emissionsbewertung

B